

710 Willow Brook Road
Boulder, Colorado

Main Level - 2702 square feet +/-
2693 finished square feet +/-
9 unfinished square feet +/-

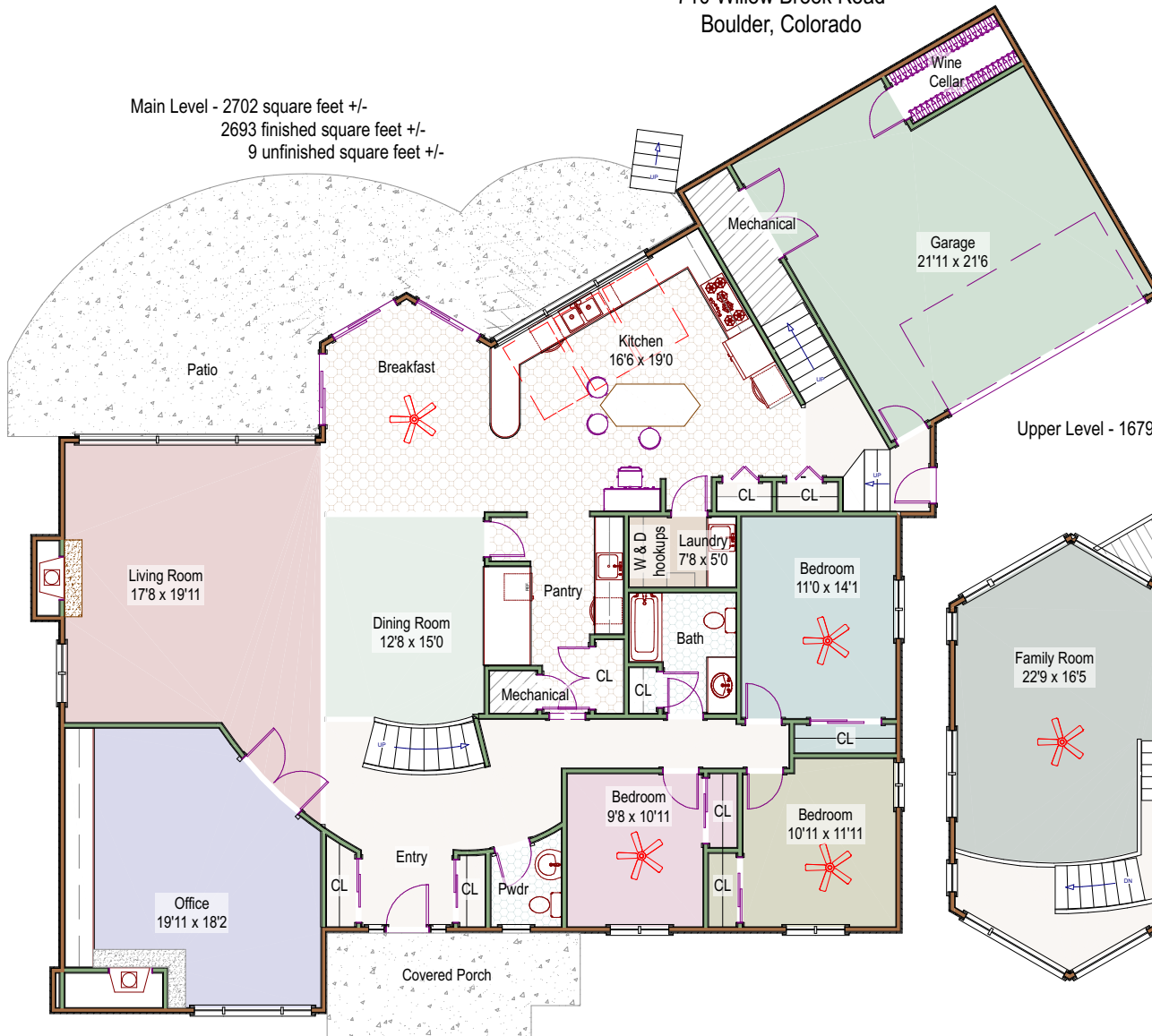

Upper Level - 1679 square feet +/-

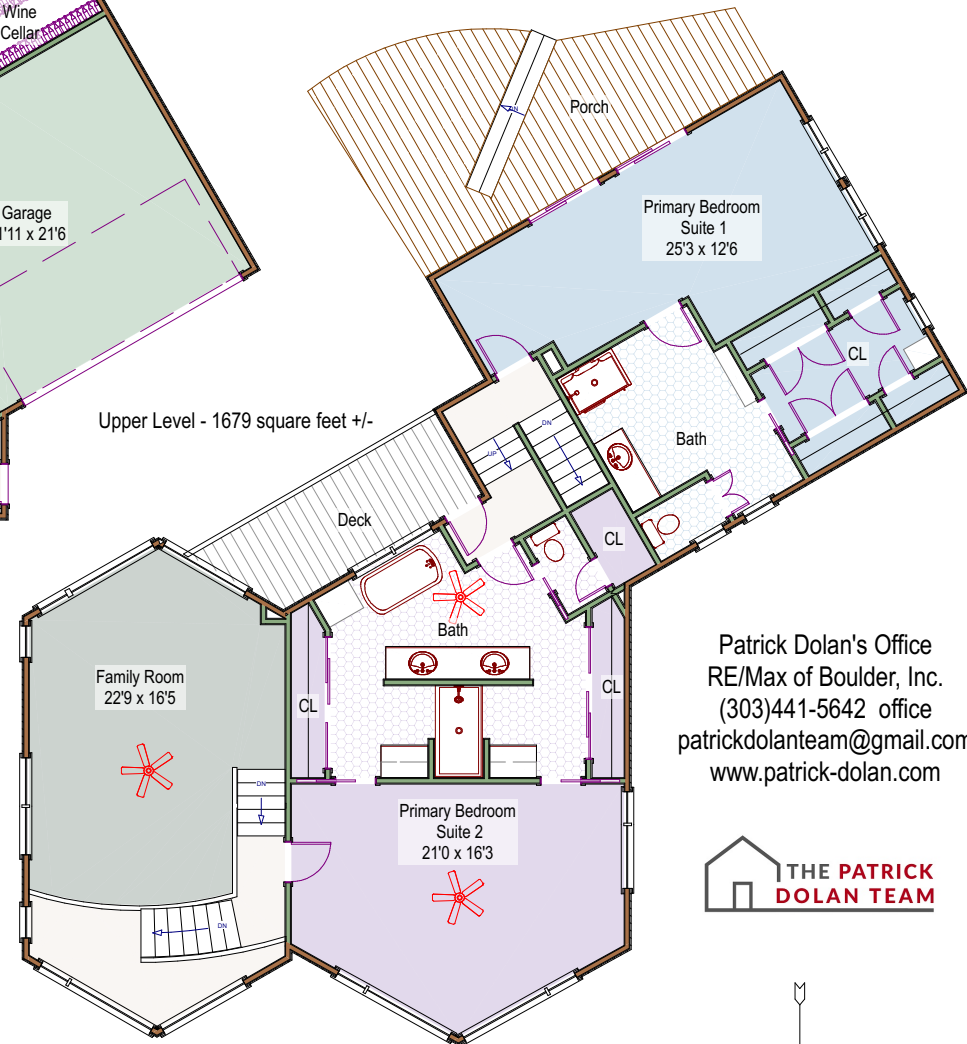

Patrick Dolan's Office
RE/Max of Boulder, Inc.
(303)441-5642 office
patrickdolanteam@gmail.com
www.patrick-dolan.com



Measurements are approximate and no responsibility is taken for any omission or mis-statement. These plans are for visual representation purposes only. Floor plan is not an architectural as-built. Square footage is determined using exterior wall dimensions and is not guaranteed. Floor plan is for the exclusive use of Patrick Dolan and may not be transferred or sold.

Floor Plans prepared by Overhead Views, (303)886-9578, esw@overheadviews.com

Property includes two detached sheds - 11'8" x 3' and 6' x 2'8"